

Rolling with EasyRise™ Two-On-One Headrail

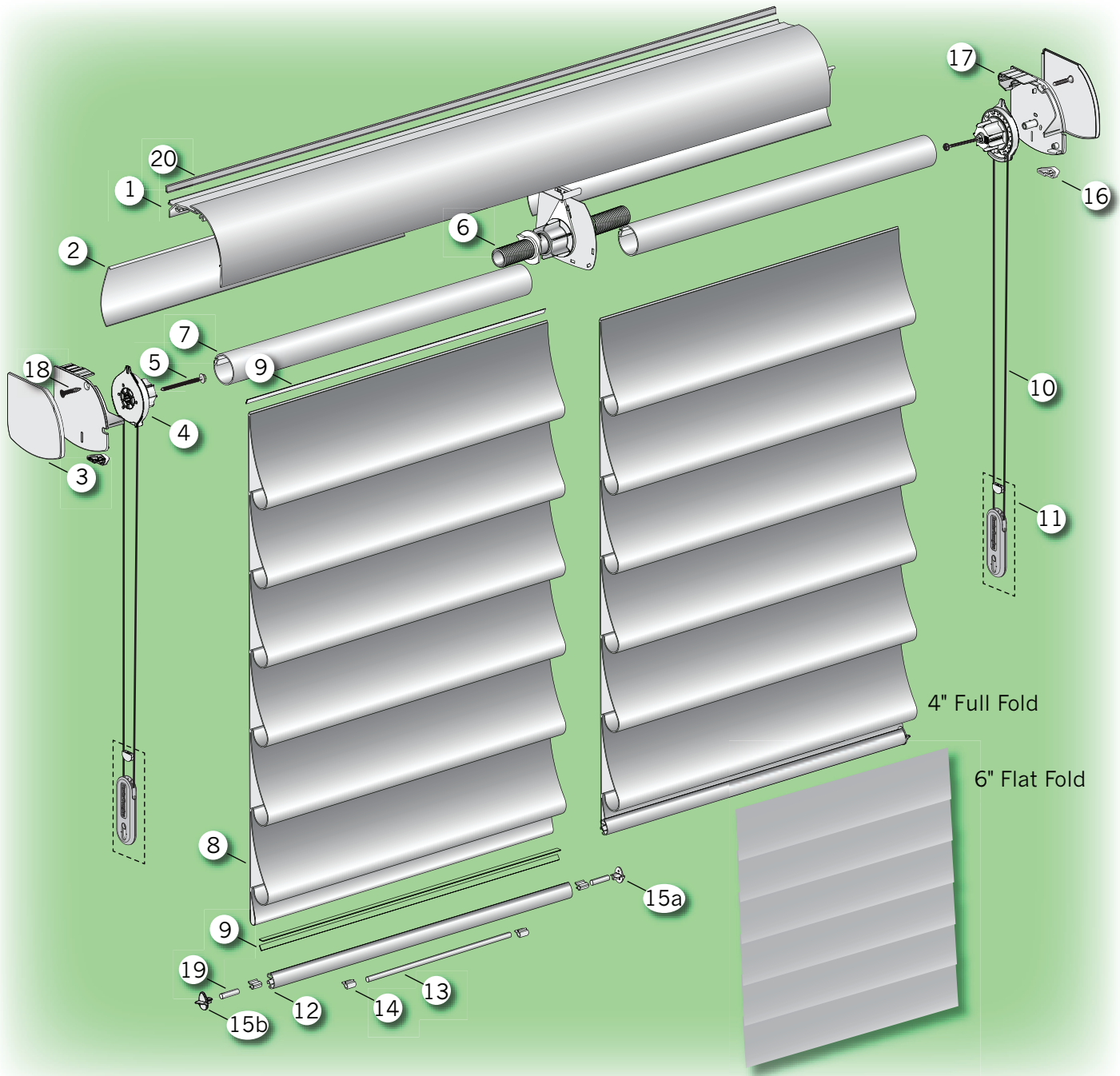

Rolling with EasyRise™ Two-On-One Headrail

No.	PCN	Description
1.	3400369320	Fabric-Covered Headrail
2.	3400320000	Fabric Guard
3.	3400669xxx	Set, Cover, End Plate
4.	3400238000	Clutch
5.	4150159000	Screw (Clutch)
6.	3402169000	Center Support Assembly
7.	3400100xxx	Rotator Rail
8.	N/A	Fabric (4" Fold Size)
9.	N/A	Poly Rod Assembly ^w /Adhesive
10.	Cord Loop (Standard Sizes)	
	4199010XXX	1'
	4199020XXX	2'
	4199030XXX	3'
	4199040XXX	4'
	4199050XXX	5'
	4199060xxx	6'
11.	4150336xxx	Universal Cord Tensioner
12.	3400350785	Bottom Rail
13.	3400210000	Bottom Rail Weight
14.	3400070785	Bottom Rail Weight Clips
15.	Bottom End Caps	
15a.	3401180xxx	End Cap Bottom ^w /Stop Tab (Inside) and Stop Tab (3 Piece Set) (See Note Below)
15b.	3401095XXX	Bottom End Cap (Outside)
16.	3402194000	Snap-In Rail Stop (Only used on shades 30" or less in length)
17.	End Plate, ER PV, Limit	
	3400674000	RH
	3400675000	LH
18.	4174708000	SU Screw, flat HD, Sq drive #8 × 0.75" Lg
19.	4600000070	1" Bottom Rail Weight (Optional – Only Used With Magnetic Hold-Down Kits)
20.	2780229001	Light Block Strip (IB Only)

NOTE: The Stop Tabs on the center bottom end caps contact the center support when the shade is fully raised. The outer end caps do not have these tabs. The End Cap Bottom ^w/Stop Tab and the Stop Tab come on a three-piece tree; the center support cover (Stop Tab) is not used.

xxx = 3-digit color code