

Installation Instructions

RB 500 Manual Roller Shades

Architectural Clutch System

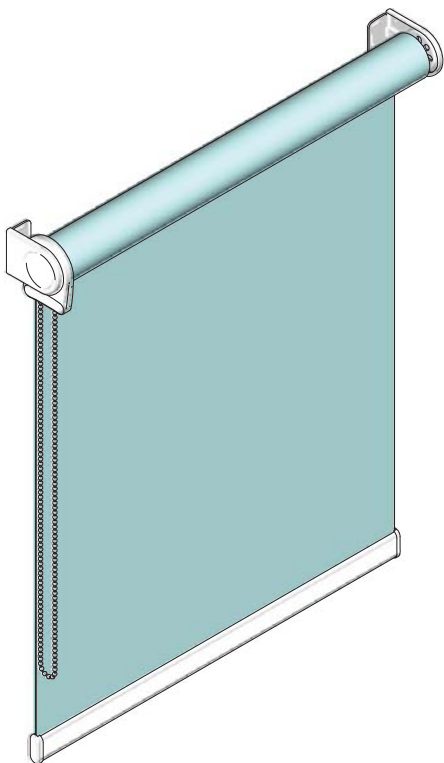

HunterDouglas 
Hospitality

Installation

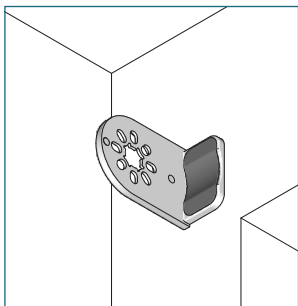
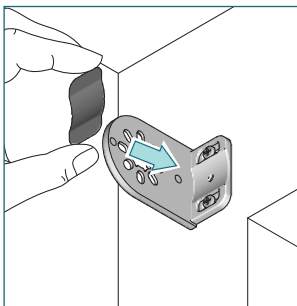

Install the brackets with the screws provided and slide the screw cover cap onto the bracket until it snaps.

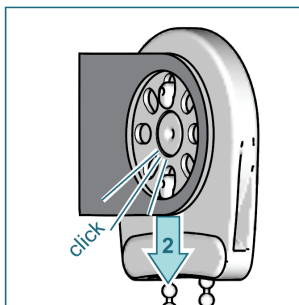
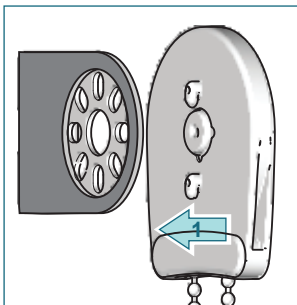

Place the clutch in the bracket (1) and slide it down until it clicks (2).

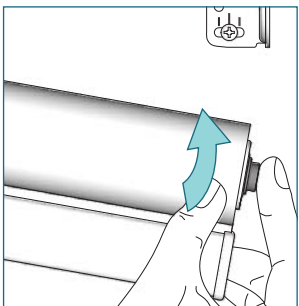
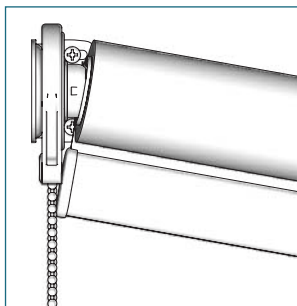

Insert the tube on to the clutch head. Press the tube bearing plug and lift the shade.

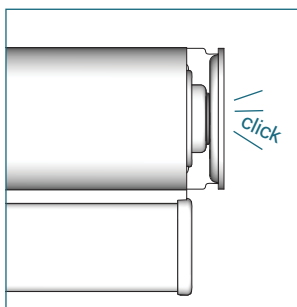

Snap it to the bracket.

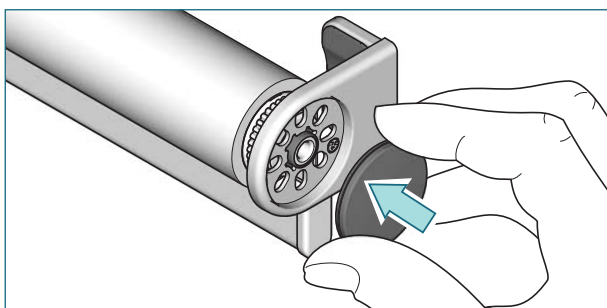

Insert the bracket cover in to the Architectural bracket.

Option: Leveling Bracket

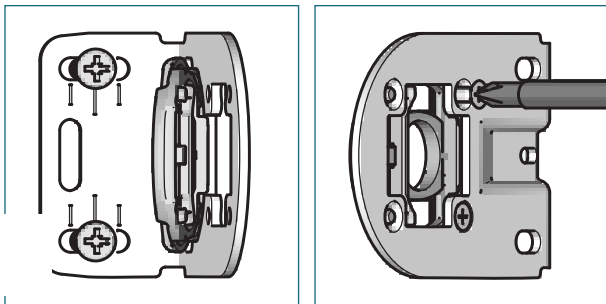

Make sure that the opening for the Allen key is pointing downwards before installing the brackets. Change the orientation by removing the 2 screws and turning the leveler 90°. Reinstall the screws.

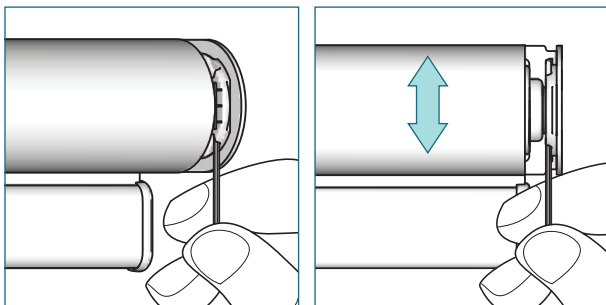

To adjust skewing, put the provided Allen key into the screw of the leveler and turn it left or right to move the shade up or down. Support lifting of large heavy shades with the palm of your hand.

Removal

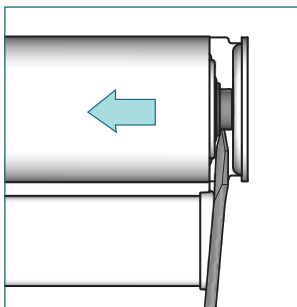

Place a screw driver between the tube bearing plug and bracket and push the bearing in the clutch direction.

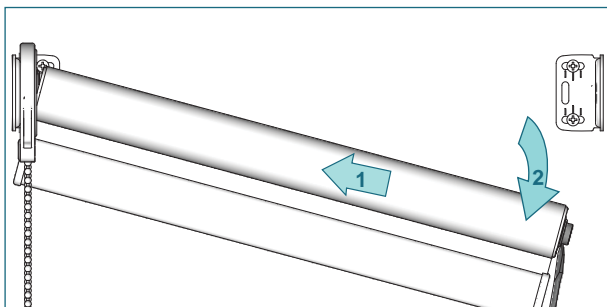

Move the shade downwards out of the bracket.

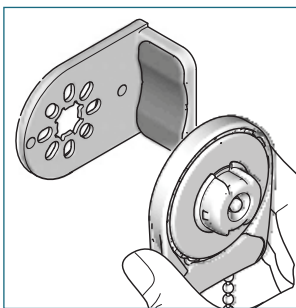
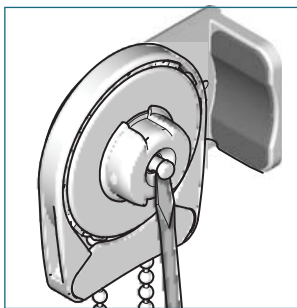

Place a screw driver under the pin of the clutch and pull it outwards. Take the clutch out of the bracket.

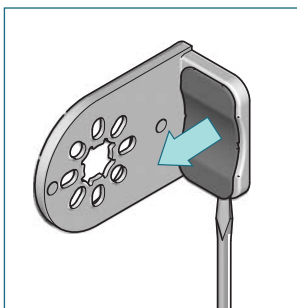
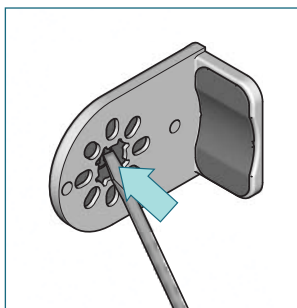

Press the bracket cover out of the decorator bracket.
Use a screw driver to remove the screw cover cap
from the decorator bracket.

Manual Shade Installation

SETTING LIMITS

ITEMS NEEDED

- Metal ball stops (provided with shade)
- Pliers

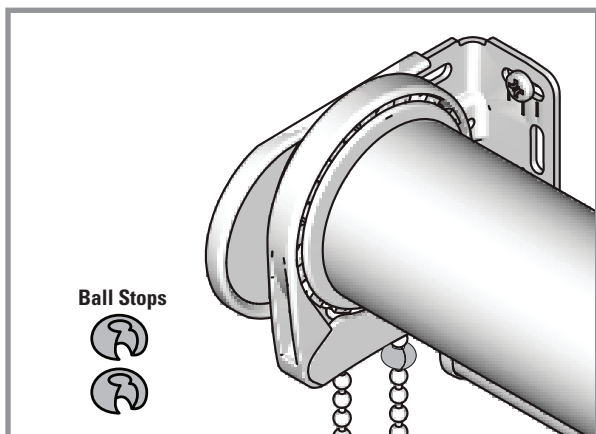

SET LOWER LIMIT

Lower shade to the bottom of the window opening. Once the shade is at the bottommost point, place one of the ball stops provided over the chain in front of the clutch mechanism. With a pair of pliers, squeeze the ball stop so that it cannot be removed. This will set the lower limit and not allow the chain to be pulled from the back any further.

SET UPPER LIMIT

To set the upper limit, raise the shade to the desired height. Place the other ball stop provided over the chain in back of the clutch mechanism. With a pair of pliers, squeeze the ball stop so that it cannot be removed. This will not allow the chain to be pulled from the front any further.

CORD TENSIONER INSTALLATION

The cord tensioner will come locked in place.

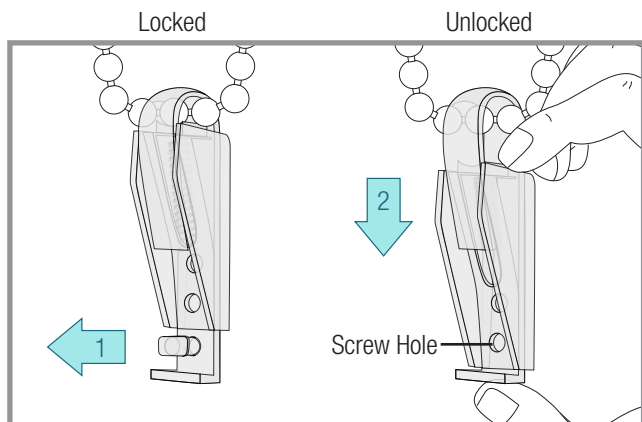

To unlock, remove the plug from the screw hole and push down.

MARK SCREW LOCATION

The cord tensioner is attached with one screw through the screw hole. With the cord tensioner at the bottom of the bead chain loop, position it at the desired location.

IMPORTANT: Hold the cord tensioner firmly in place and check that the bead chain can move freely through it.

- If the bead chain does not move freely through the cord tensioner, it is too tight and the cord tensioner should be moved up.
- If the cord tensioner locks onto the bead chain, it is too loose and the cord tensioner should be moved down.

Mark screw hole with a pencil.

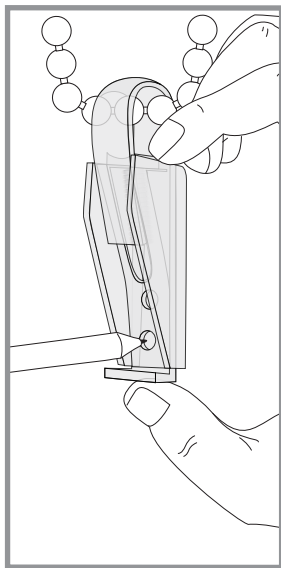

IMPORTANT: Locate the cord tensioner as close to the window glass as possible to minimize accessibility by children and pets.

Be sure the cord tensioner is not placed in the path of the bottom rail and fabric.

CORD TENSIONER INSTALLATION

CAUTION: Use wall anchors if the mounting screws will not be secured into wood or metal. For metal surfaces, sheet metal screws are recommended.

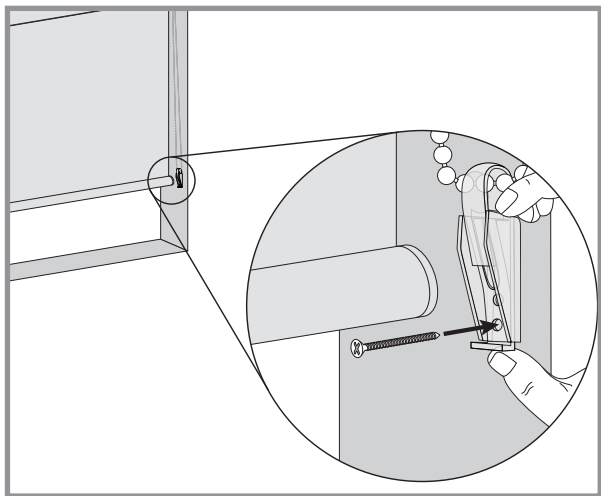

MOUNT CORD TENSIONER

Determine whether or not a wall anchor is required and drill either a 1/8" pilot hole (no wall anchor) or a 7/32" pilot hole (with wall anchor). Attach the cord tensioner directly to the wall using a 1½" screw. If a wall anchor is required, first tap the anchor into the pre-drilled hole. Ensure the bead chain can move freely through the cord tensioner without engaging the lock. The screw hole should be at the bottom of the cord tensioner ($\pm 1/8"$).



WARNING

For more safety information call
1-888-501-8364 in the U.S. or
1-866-662-0666 in Canada.

YOUNG CHILDREN CAN STRANGLE IN BEAD CHAIN LOOPS. THEY CAN ALSO WRAP BEAD CHAINS AROUND THEIR NECKS AND STRANGLE.

- ALWAYS KEEP BEAD CHAINS OUT OF THE REACH OF CHILDREN.
- MOVE CRIBS, PLAYPENS, AND OTHER FURNITURE AWAY FROM BEAD CHAINS. CHILDREN CAN CLIMB FURNITURE TO GET TO BEAD CHAINS.
- ATTACH THE CORD TENSIONER ON THE BEAD CHAIN LOOP TO THE WALL OR WINDOW CASEMENT. THIS CAN PREVENT CHILDREN FROM PULLING BEAD CHAIN LOOPS AROUND THEIR NECKS.
- FASTENERS PROVIDED IN THIS KIT MAY NOT BE APPROPRIATE FOR ALL MOUNTING SURFACES. USE APPROPRIATE ANCHORS FOR THE MOUNTING SURFACE CONDITIONS.
- FOR THE WINDOW COVERING TO OPERATE PROPERLY, THE CORD TENSIONER MUST BE CORRECTLY MOUNTED AND SECURED, AS EXPLAINED IN THESE INSTRUCTIONS.
- ONLY SUPPLIED HARDWARE SHOULD BE USED. REPLACEMENT PARTS MAY BE OBTAINED BY CALLING:

1-888-501-8364 IN THE U.S. OR 1-800-265-8000 IN CANADA