

### TOOLS NEEDED



Pencil



Measuring  
Tape



Level



Drill with  
bits



Screwdriver

### INSTALLING A POCKET

#### SURFACE/WALL MOUNT

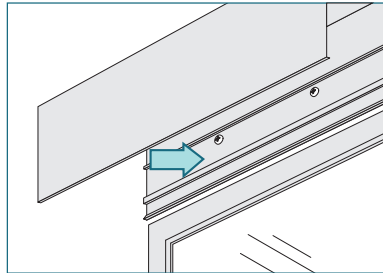

Mount into wood or metal studs or into concrete with concrete anchors. Drywall anchors are not recommended.

Determine the mounting location.

Pre-drill the pocket. Mount in place.

#### END PLATES

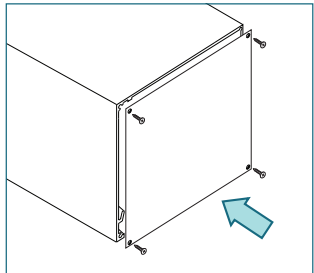

Use a screwdriver to attach the end plates with the screws provided.

#### BOTTOM CLOSURES

Side View

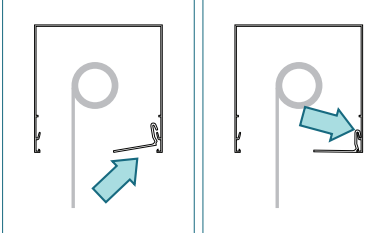

Tilt the bottom closure inside the front edge of the pocket until the closure catches on the inside ledge.

#### Manual Single Shade

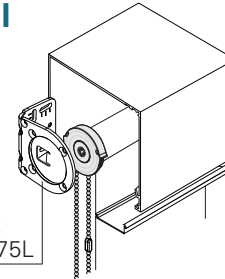

Manual  
Bracket  
55L or 75L

Surface Mounted  
Use bracket and shade instructions for Standard+ & Heavy Duty+ Manual

#### Motorized Single Shade

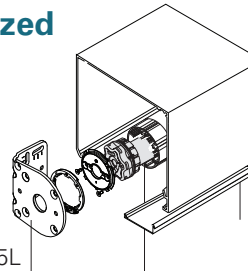

Motor  
Bracket  
55L or 75L

Surface Mounted  
Use bracket and shade instructions for RB 500 Heavy Duty Bracket Motorized

#### Dual Shade 9" Pocket Only

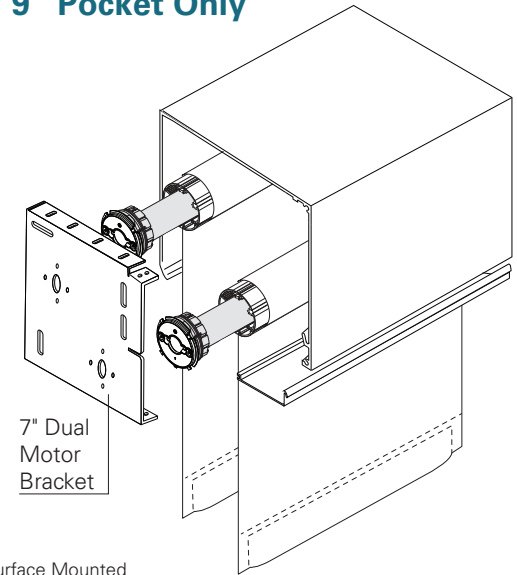

7" Dual  
Motor  
Bracket

Surface Mounted  
Use bracket and shade instructions for Heavy Duty+ 7" Dual Bracket Motorized or Manual

## Sonesse 50 RTS 506S2 & 510S2 Motor with **Coupled Heavy Duty Brackets in Pocket** Motorized Shade Installation Series 5-267–216

### TOOLS NEEDED



Pencil



Measuring  
Tape



Level



Drill with  
bits



Screwdriver



Allen Key  
(provided with  
optional Leveler)



Pliers

### Compatible Motors

LT50 RA 525A2  
LT50 Altus RTS 525A2  
Sonesse 50 RTS 506S2  
Sonesse 50 DCT 506S2  
Sonesse 50 RA 506S2  
Sonesse 50 RS485 506S2  
Sonesse 50 RTS 510S2  
Sonesse 50 DCT 510S2  
Sonesse 50 RA 510S2  
Sonesse 50 RS485 510S2  
Sonesse ULTRA 50 RTS 506A2  
Sonesse ULTRA 50 RA 506A2  
Sonesse ULTRA 50 RS485 506A2  
LT50 RS485 515S2  
LT50 RS485 535A2  
Sonesse ULTRA 50 DC RTS 504A8  
Sonesse 50 DC RS485 504A8  
Sonesse 30 RTS  
Sonesse 30 DCT  
Sonesse 30 RS485

### INSTALLING THE BRACKETS

#### RB 500 HEAVY DUTY BRACKETS IN A POCKET

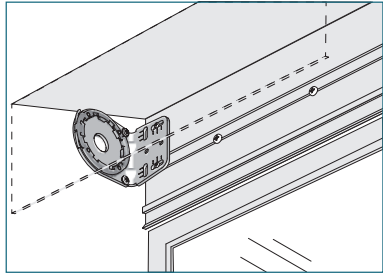

- Determine the mounting location inside the pocket.
- Measure and mark the bracket locations with a pencil.
- Mount brackets with the screws provided. Pre-drilling is recommended.
- Check that the brackets are level and aligned.

#### SCREW COVERS

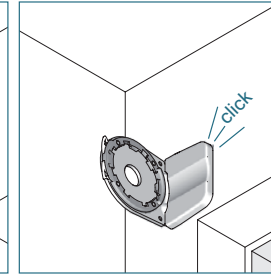
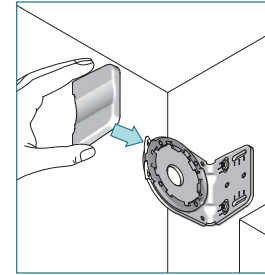

Slide the screw  
cover cap onto  
the bracket  
until it snaps.

### OPTIONAL: INTEGRATED LEVELER

#### IDLE END

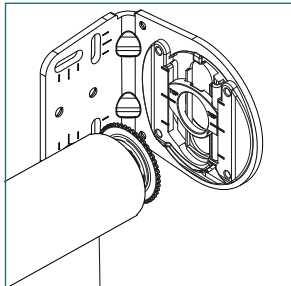

#### ADJUST LEVELER

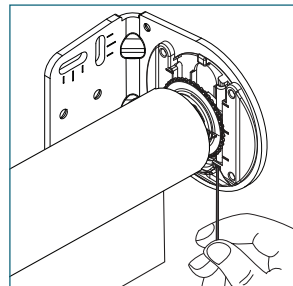

Insert the provided Allen key into the set screw of the leveler.

Adjust skewing by turning the Allen key left or right to move the shade up or down. Support the shade with your hand if necessary.

All adjustments can be made after the shade has been installed and after the operation has been tested.

### MOTORS

Sonesse 50 RTS 506S2 & 510S2 120V AC

Plug-In

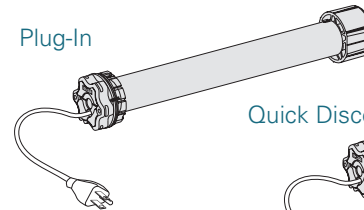

Quick Disconnect

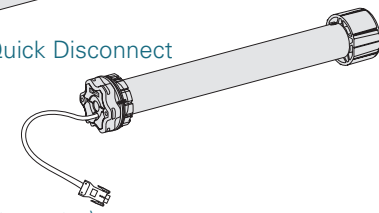

Motor Front Plate  
(comes attached to motor)

## Sonesse 50 RTS 506S2 & 510S2 Motor with **Coupled Heavy Duty Brackets in Pocket** Motorized Shade Installation Series 5-267-216

### INSTALLING THE SHADE - Do not remove the tape around the shade until it is fully installed

#### INSTALL INTO IDLE BRACKET

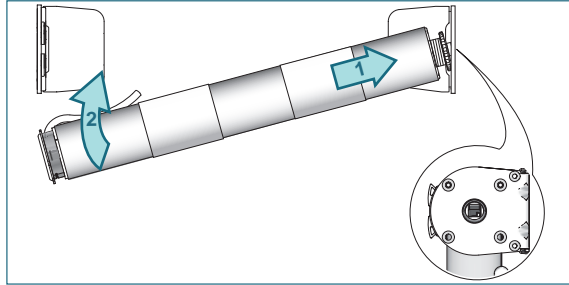

Place the roller shade end plug into the idle end bracket. Push the shade against the idle end and lift the motor end up.

#### INSTALL INTO MOTOR BRACKET

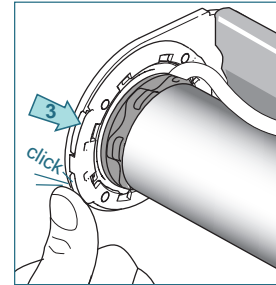
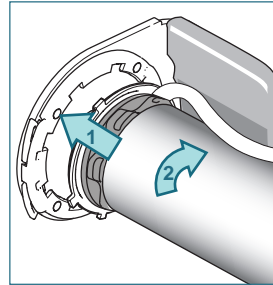

Fit the motor front plate into the motor bracket.

Turn the shade approximately 10° in the rolling direction.

Close both bracket fasteners.

### MOUNT OUTER BRACKET AND COUPLER

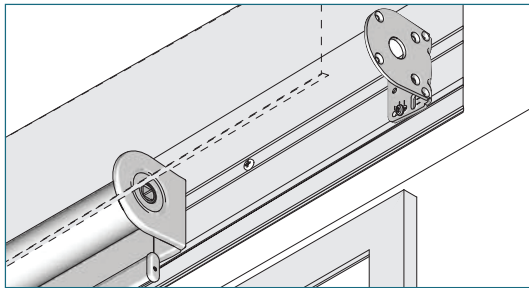

Fix the outer bracket inside the pocket with the screws provided.

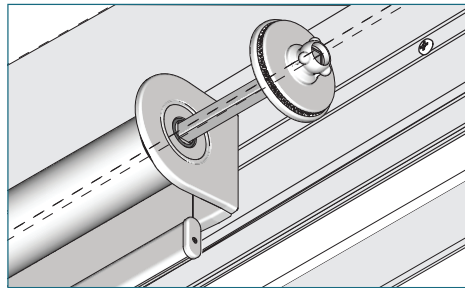

Slide the aligner or the connector through the bracket into the idle end.

#### COUPLING 2 INTERMEDIATE BRACKETS

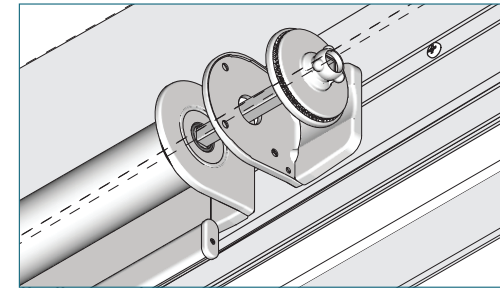

Fix the inner bracket with the screws provided. Slide the aligner or the connector through the bracket into the idle end.

### MOUNT THE COUPLED SHADE

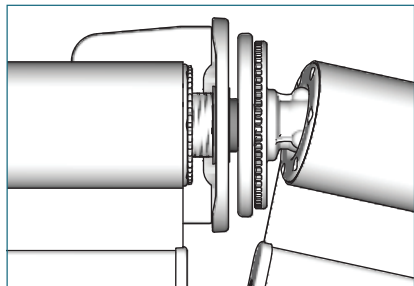

Place the tube with plug connector on the aligner or connector set head.

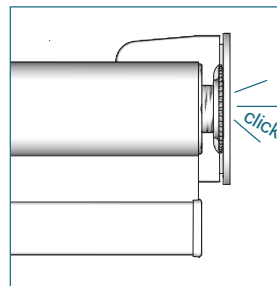
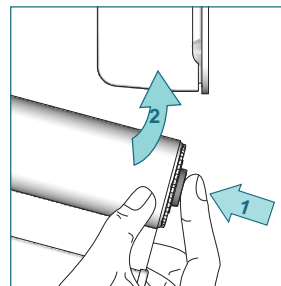

Press the tube bearing plug, lift the roller shade and snap into the idle bracket end.

#### ALIGNER SET ADJUSTMENT

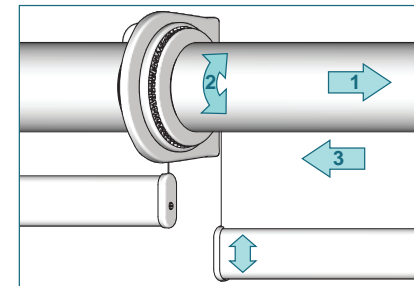

To align the bottom hembars, pull the shade away from the aligner set (1), turn the shade to line up the bottom hembars together (2). Release the shade to secure the position (3). Not possible when using a connector set.

## Sonesse 50 RTS 506S2 & 510S2 Motor with **Coupled Heavy Duty Brackets in Pocket** Motorized Shade Installation Series 5-267-216

### LOCK THE SHADE

#### UNLOCKED

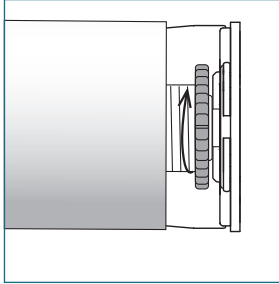

#### LOCKED

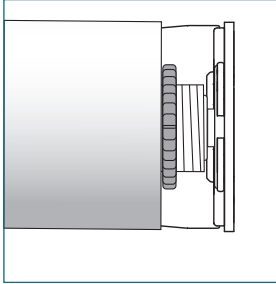

Rotate the nut on the idle end clockwise until it meets the tube. This locks the shade into position.

### CHECK SHADE OPERATION

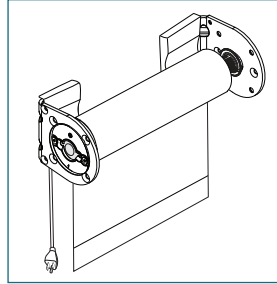

Remove the tape from the shade.

Make sure the shade operates properly. Use separate wiring information per motor type and programming instructions from [HDhospitality.com](http://HDhospitality.com)

Adjust leveler if applicable.

### SHADE REMOVAL

#### DISCONNECT THE MOTOR

Disconnect the power cable from the electrical source.

Unplug from the outlet or disconnect the quick disconnect plug.

#### UNLOCK THE SHADES

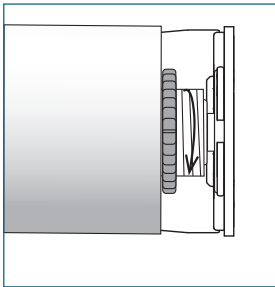

Rotate the nut on the idle end counterclockwise to unlock the shade.

#### REMOVE COUPLED SHADE FIRST

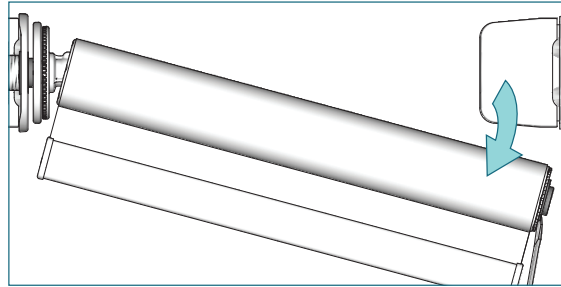

Place a screwdriver between the bracket and bearing plug and push towards the aligner to remove the shade. Move the shade downward and out of the bracket. Remove the aligner or connector from the bearing plug.

#### RELEASE THE MOTOR END OF THE SHADE

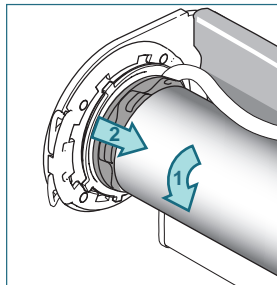
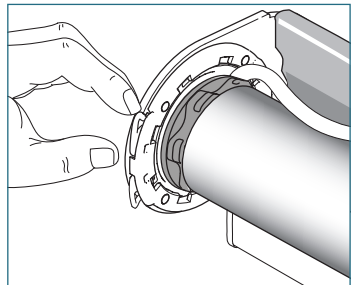

Open the bracket fasteners.

Turn the shade in the roll up direction until the motor front plate releases.

Push the shade in the direction of the idle bracket and slide it out of the bracket.

#### REMOVE THE SHADE

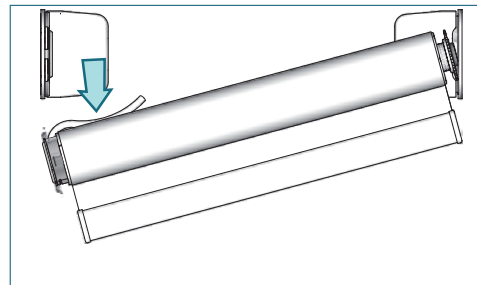

Move the shade downward and out of the brackets.