

# EasyRise™ Bottom-Up (Standard)

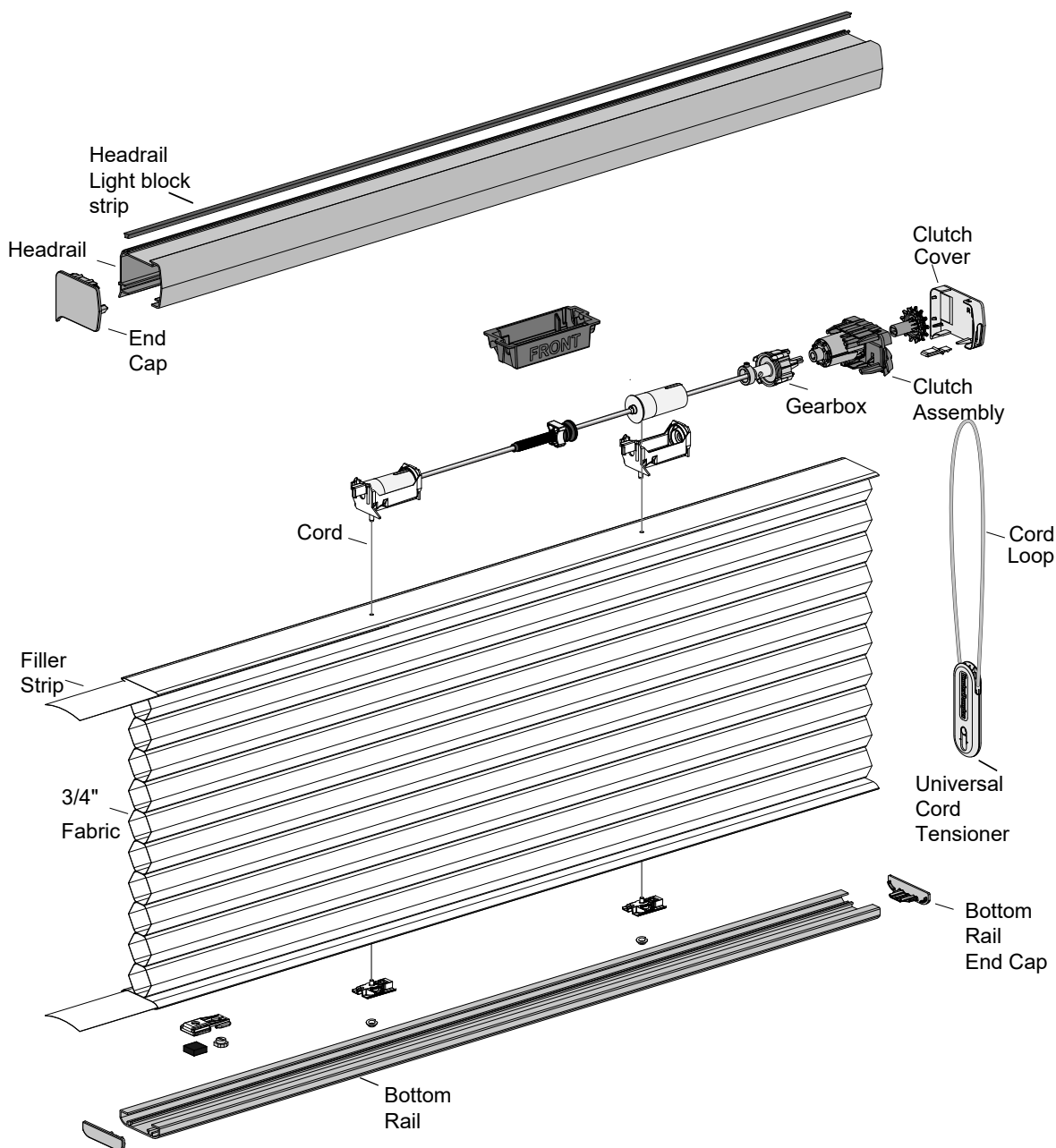

## SPECIFICATIONS

Minimum Width **16"**  
 Maximum Width **144"**  
 Minimum Height **24"**  
 Maximum Height **144"**  
 Maximum Square Feet **80**  
 Hardware Color **Coordinates with the fabric**  
 Cord Drop **2', 3', 4' & 5' - length determined by shade height; Cords longer than 5' come in white only**

## MOUNTING REQUIREMENTS

Inside Mount Minimum Depth **1/2"**  
 Inside Mount Minimum Depth Fully Recessed **2-1/4"**  
 End Mount Minimum Depth **1-1/4"**  
 End Mount Minimum Depth Fully Recessed **2-3/8"**  
 Outside Mount Surface Height **1-1/4"**

Hunter Douglas Hospitality's products vary in weight and require specific mounting points. Suitable mounting surface and structural support where needed is to be provided by others.

**HunterDouglas**  
 Hospitality