

DecoFlex Wirefree RTS Wall Switch

Motorization

Radio Technology Somfy® (RTS) wall switches allow for up to a 65 ft. control range. The radio waves travel through walls eliminating the need to point or aim the transmitter at the window covering. With a simple press of a button, users have the ability to control all motorized window coverings individually and/or as a group with one control.

WIREFREE WALL SWITCH

- Recommended control for hospitality settings
- Available in 1 Channel, 2 Channel, and 5 Channel
- Channel buttons can be custom engraved for easy organization

**1 Channel
RTS Wall Switch**



**2 Channel
RTS Wall Switch**



Available finishes:

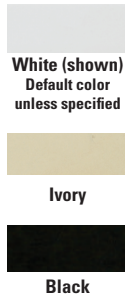

5 Channel RTS Wall Switch

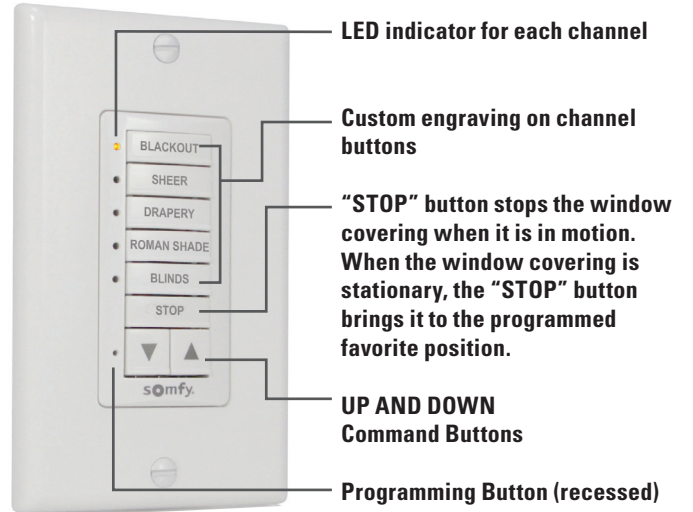

INSTALLATION FEATURES

- Mounting bracket attaches to drywall
- No need for an electrical box (If used, it must be plastic)
- Switch can be installed anywhere up to 65 ft from the motor

NOTE:

For guest room installation, it is recommended to mount the wall switch near the shade it will control to insure guests are aware of motorization operation.

RTS Wall Switch Installation Items

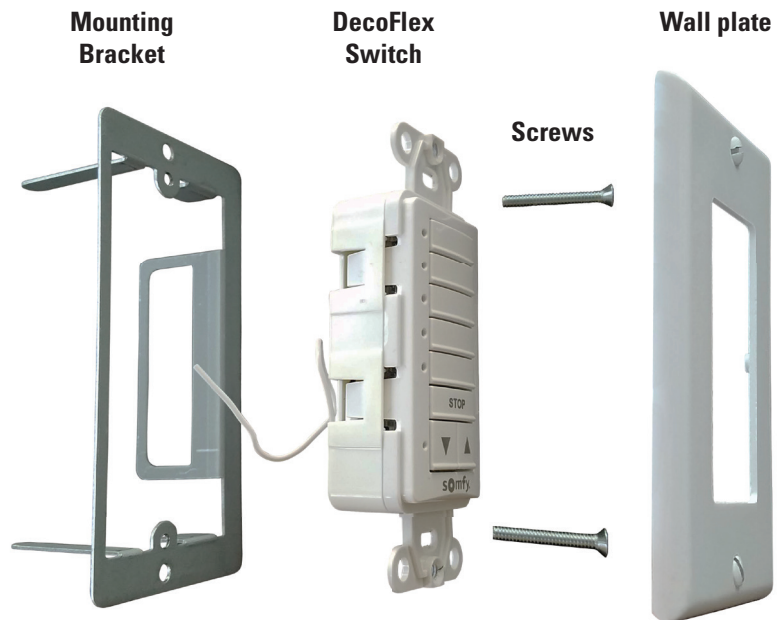

DecoFlex Wirefree™ RTS Wall Switch Instructions

Assembly/Installation/
Operating Instructions
(Ref: 1810813 +others)

ASSEMBLY

ASSEMBLE MULTIPLE BUTTON SWITCHES

- 1 Begin with a standard (assembled) 1 or 5 control button DecoFlex switch. Using a small flat blade screw driver, carefully separate the SWITCH BASE ASSEMBLY from the FACEPLATE (as shown in figure 1).
- 2 Add or remove CONTROL BUTTONS (as required) from the SWITCH BASE ASSEMBLY (as shown in figure 2). Be certain the SWITCH BASE ASSEMBLY remains intact.
- 3 Attach new multiple button face plate (as shown in figure 3 & 4).



Figure 1.



Figure 2.

5 Channel DecoFlex Wall Switch (Exploded view)

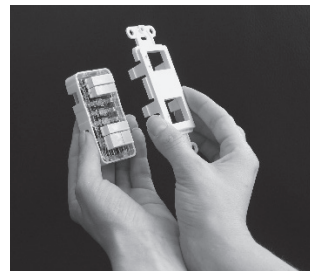
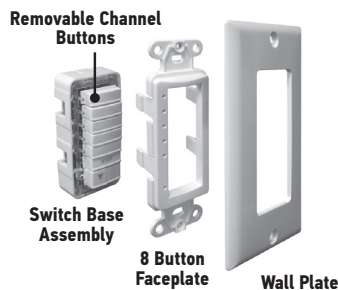

Figure 3.

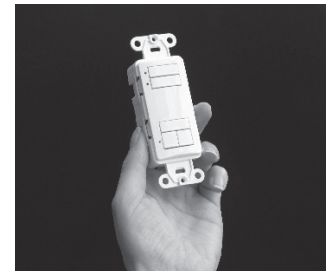

Figure 4.

REPLACE STANDARD CONTROL BUTTONS

- 1 Using a small flat blade screw driver, carefully separate the SWITCH BASE ASSEMBLY from the FACEPLATE (as shown in figure 1).
- 2 Replace standard (blank) or temporarily labeled CONTROL BUTTON(S) with new engraved CONTROL BUTTON(S).
- 3 Attach new CONTROL BUTTON FACE PLATE (as shown in figure 3 & 4).



5 Button
Switch Assembly



6 Button
Switch Assembly



7 Button
Switch Assembly

Battery Replacement:

The DecoFlex WireFree™ RTS switch is designed to provide years of maintenance-free performance. Should the battery become discharged, the LED indicator lights will no longer function when the channel button is selected or an up, stop or down command is activated. As a result, the radio signal will be reduced or not communicated to the RTS receiver or motor.

The battery can be easily replaced by exposing the SWITCH BASE ASSEMBLY board of the DecoFlex WireFree™ switch. Simply slide the battery out of its holder and replace with a new 3V Lithium battery (type 2450) maintaining the correct polarity.

NOTE: Batteries should be disposed of properly according to local regulations.

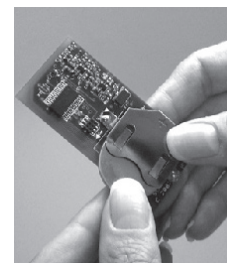

INSTALLATION

Included is a special SOMFY low voltage device mounting bracket which attaches to drywall and eliminates the need for an electrical box. The bracket can be used in two mounting type configurations:

- 1 Individual or "stand-alone" (1 switch) mounting configurations (shown below),
- 2 Or adjacent (pre-existing) Decora-style light switch (specific instructions available). This unique mounting bracket allows the necessary spacing for 2 adjacent switches and a new "Double Gang" (2 Gang) wall plate to be installed (see photo 8) resulting in an aesthetically pleasing professional installation

NOTE: When following configuration 1, the mounting bracket is not designed to be used in conjunction with "old-work" or retrofit electrical boxes. (Please check local codes to determine if an electrical box is required for your installation.) For increased radio performance, Somfy recommends the use of non-metallic electrical enclosures.

Tools required for installation:

Screw drivers (Phillips and bladed), dry-wall saw, wall stud sensor, non-marring tape and pencil

- 1 Pick a location for the switch and using a stud sensor, locate a space between studs and mark (for reference) with removable tape or pencil.

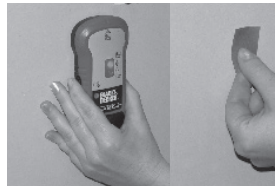

- 2 Place the flat side of mounting bracket (included) against the wall, then trace the inside shape of the bracket on wall using a pencil or thin marker.



- 3 Using a dry-wall saw (or similar) begin to cut the drywall along the traced outline. Do not cut hole larger than outline as this may result in a loose fitting bracket.

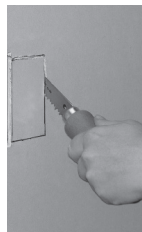

NOTE: Recommended hole dimensions are (1 5/8" W x 3 7/16" L)

- 4 Insert bracket (as shown) into hole and carefully bend bracket tabs 90 degrees behind the dry-wall to ensure a tight secure fit.

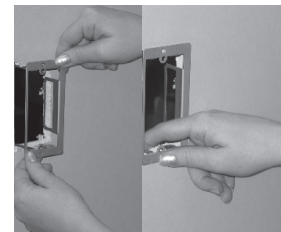

- 5 Position the DecoFlex switch into mounting bracket aligning the screw holes. Secure switch with screws (provided).

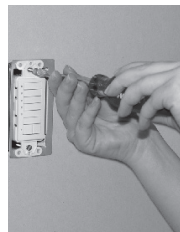

- 6 Attach a Decora-style wall plate over the switch to complete installation.

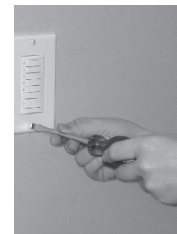

OPERATION

- 1 Select the CONTROL BUTTON(s) programmed to a specific window covering(s). The adjacent LEDs will illuminate to indicate the CONTROL BUTTON selected.
- 2 To raise the window covering(s), press the **UP** button. To lower the window covering(s), press the **DOWN** button.
- 3 To stop the window covering(s) at any time, simply press the **STOP** button.
- 4 For wall switches programmed to use group function, select a control button followed by an action (default: Up, Stop and Down).

For detailed product operation information, refer to the product programming instructions.

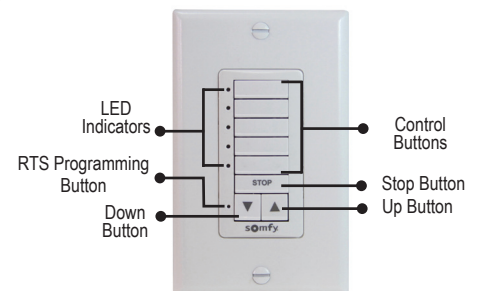

NOTE: Switches require programming in order to operate as intended.

SAVE THESE INSTRUCTIONS FOR FUTURE REFERENCE

DecoFlex WireFree™ RTS Switch

**To ensure accuracy, please be sure this document has been printed as “Actual Size.”
Please verify using measurements provided.**

Align the thin side of the template on existing electrical box (opposite stud side).
Align the mounting screw height with existing switch.
Trace the inside shape of the bracket on the wall.
Cut the drywall along the traced outline.

NOTE: Do not cut hole larger than outline as this may result in a loose fitting bracket.

*For complete installation information, please refer to the **Programming/Operating/Assembly Installation** Instructions.

