

# Classic Single

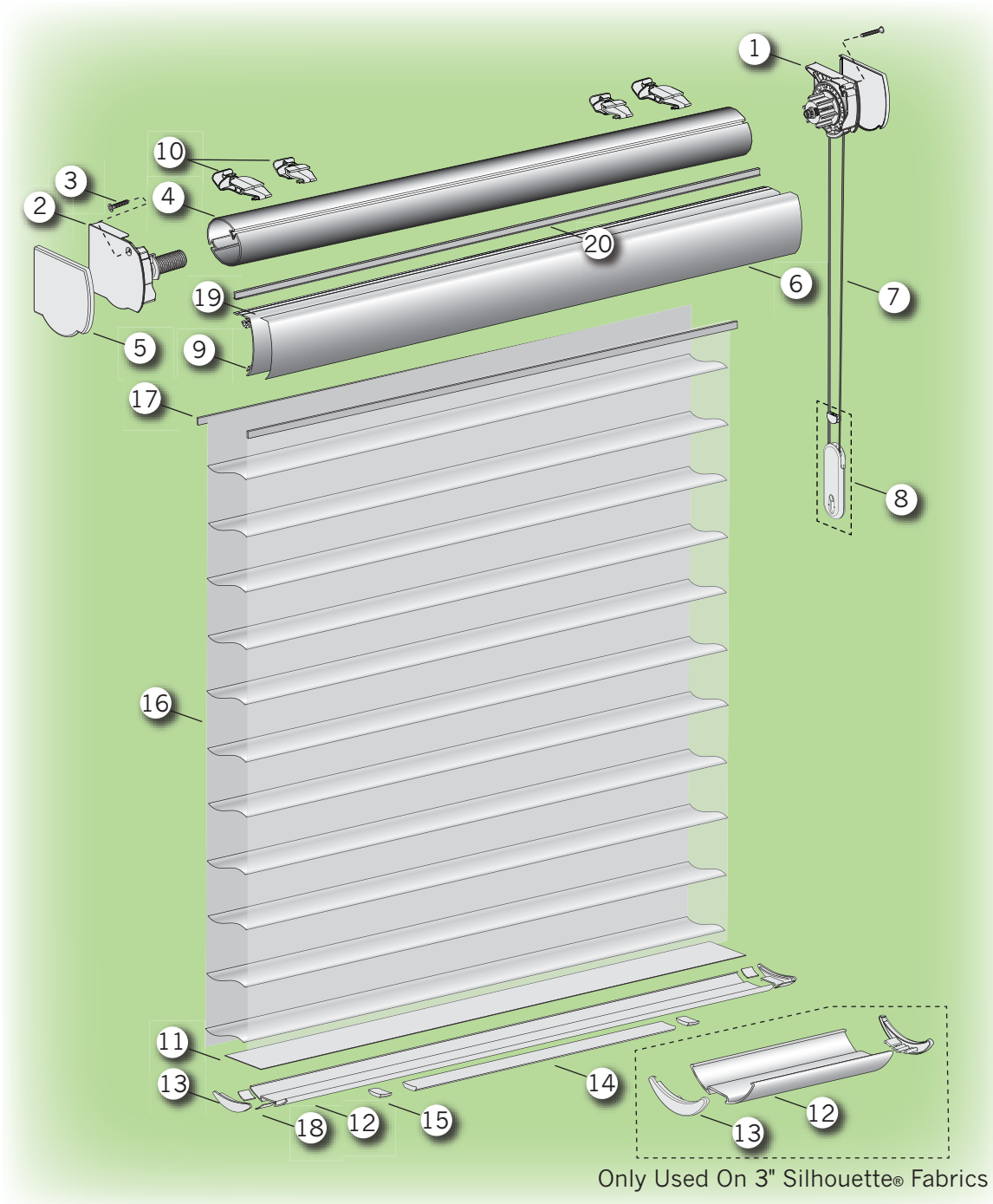

# Classic Single

<b>No.</b>	<b>PCN</b>	<b>Description</b>
1.	Headrail Clutch End Plate	
	4170417000	RH
	4170418000	LH
2.	Idler Assembly	
	4170439000	RH
	4170440000	LH
3.	4174708000	Screw, FLH PHH #8-18 x 0.75"
4.	4150054xxx	Rotator Rail, 0.050 LW, Universal
5.	End Cap Cover	
	4171291xxx	RH
	4171292xxx	LH
6.	N/A	FCH Fabric
7.	Cord Loop	
	4199010xxx	1'
	4199020xxx	2'
	4199030xxx	3'
	4199040xxx	4'
	4199050xxx	5'
	4199060xxx	6'
8.	4150336xxx	Universal Cord Tensioner
9.	4171290xxx	Headrail, Fabric Covered
10.	Top Limit	
	4150057885	Std. Used On 2" Silhouette And 3" Nantucket Fabrics
	4140126000	XL Used On All 3" Silhouette Fabrics
11.	Bottom Slat	
	4150144xxx	SU BTTMSLAT 2" (1.908" Vane)
	4160144xxx	SU BTTMSLAT 3" (2.5625" Vane)
12.	Bottom Rail	
	4150128xxx	Classic – 2" Silhouette Fabrics And 3" Nantucket Fabrics
	4150951xxx	3" – All 3" Silhouette Fabrics
13.	Bottom Rail End Caps	
	4150084xxx	Classic – All 2" Silhouette Fabrics And 3" Nantucket Fabrics
	4170950xxx	3" – All 3" Silhouette Fabrics
14.	4150082xxx	Balance Weight
15.	4150083xxx	Weight Clips
16.	N/A	Fabric
17.	4150288785	Polystrip With Tape
18.	SU Steel Insert Strip	
	4150600000	Short
	4140601000	XL, Long – All 3" Silhouette Fabrics
NOTE: For 3" bottom rail, use one short and one long steel insert strip on each side.		
19.	4150153500	SU FW Tape, 3.219" × 320 Yards
20.	2780229000	Light Block Strip (IB Only)

xxx = 3 Digit Color Code