

# RB 500™ Coupled Shade - **Heavy Duty+** Clutch

## Diagram

### SPECIFICATIONS

Mount: **Ceiling, Wall, or End Mount**  
 Tube Size: **50mm (2") and 62mm (2.5")**  
 Shade Weight: **9 lbs**  
 Shade Weight with Spring Assist: **13 lbs**  
 Minimum Width with Spring Assist: **35"**  
 Shade Weight with Counter Balance System: **20 lbs**  
 Minimum Width with Counter Balance System: **35"**  
 Light Gap: **Clutch End – 1"**  
               **Middle – 1.5"**  
               **Idle End – 7/8" (.875")**

Chain: **Stainless Steel with 110 lb breaking strength**  
 Clutch Color: **Grey**  
 Bracket Color: **Grey**  
 Bracket Cover Colors: **Black, Grey, & White**  
 Hembar: **Shade fabric determines which hembar is available**

Bracket	Dimensions	Max Roll Up
<b>Bracket 55L</b>	<b>3.46" H x 2.56" W x 3.9" D</b>	<b>3.8"</b>
<b>Bracket 75L</b>	<b>3.46" H x 2.56" W x 4.69" D</b>	<b>5.4"</b>

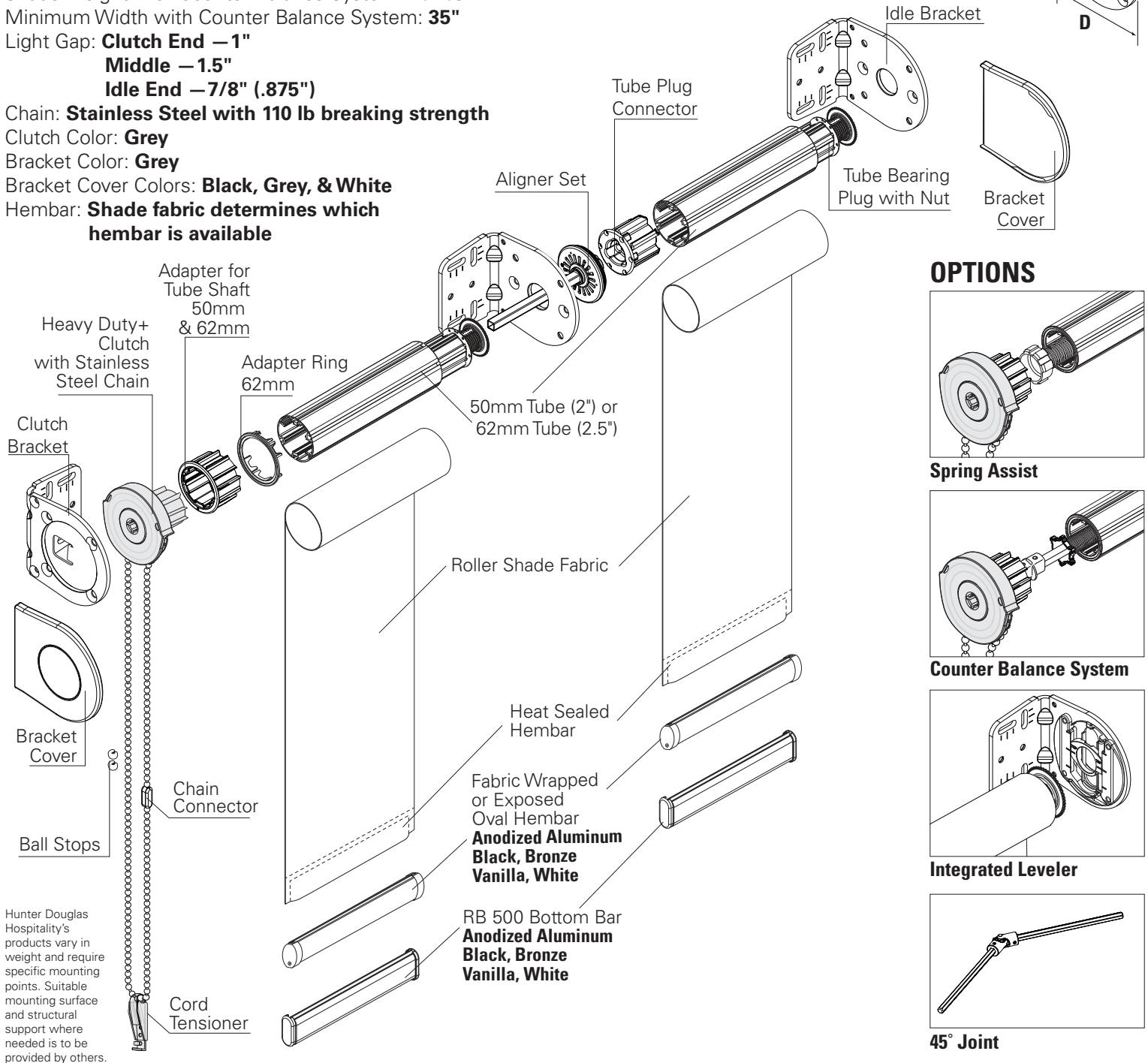
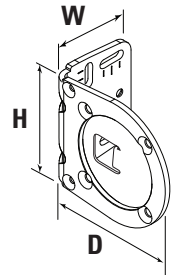

### OPTIONS

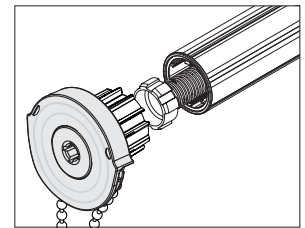

**Spring Assist**

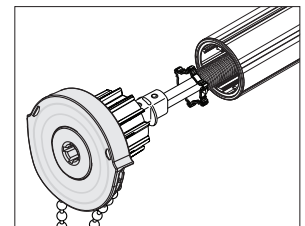

**Counter Balance System**

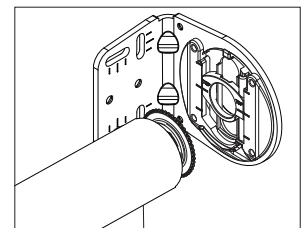

**Integrated Leveler**

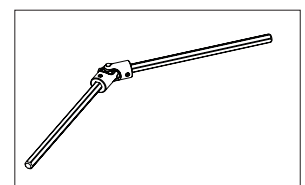

**45° Joint**

Las Vegas • Chicago  
 800.229.5300  
 HDhospitality.com

© 2018 Hunter Douglas. All rights reserved. All trademarks used herein are the property of Hunter Douglas or their respective owners.

