

# RB 500™ 5.25" Pocket Single Shade - Sonesse 30 WireFree RTS Motor

## Diagram

Series 5-216

### SPECIFICATIONS

Mount: **Surface or Ceiling Mount**

Shade Width: **37mm (1.5") Tube — 30" - 80"**

Shade Width: **50mm (2") Tube — 30" - 120"**

Light Gap: **Motor End — 3/4" (.75")**

**Idle End — 3/4" (.75")**

Motor connection: **Built-in Rechargeable Battery**

Power connector: **10" Motor Charging Cable Plug**

Bracket Color: **Grey or White**

Bracket Covers: **Grey or White**

Hembar: **Shade fabric determines which hembar is available**

Control Options: **Wireless Wall Switch, Wireless Remote,**

**Universal Interface, Timer, Sun Sensor**

**mylink™ RTS Smartphone, Tablet**

**and Amazon Alexa Interface**

Bracket	Dimensions	Max Roll Up
<b>Bracket 38</b>	<b>1.96"H x 1.22"W x 2.44"D</b>	<b>2-1/2" (2.5")</b>
<b>Bracket 46</b>	<b>1.96"H x 1.22"W x 2.79"D</b>	<b>3-1/8" (3.125")</b>
<b>Bracket 55</b>	<b>1.96"H x 1.22"W x 3.14"D</b>	<b>3-7/8" (3.875")</b>

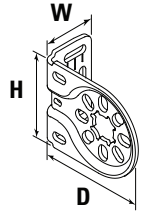

### POCKET COLORS



White

Aluminum

### OPTIONS

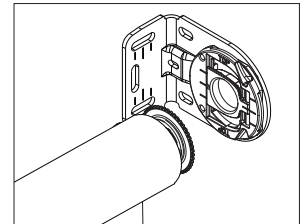

Integrated Leveler

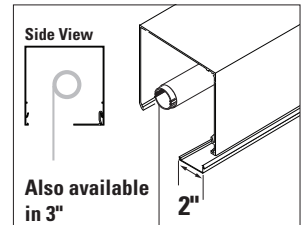

Bottom Closures

(May need to be secured to pocket)

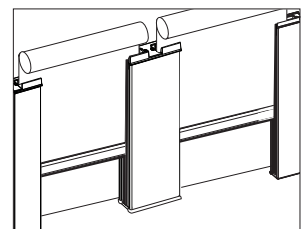

Side and Middle Channels

### Plug-In Charger

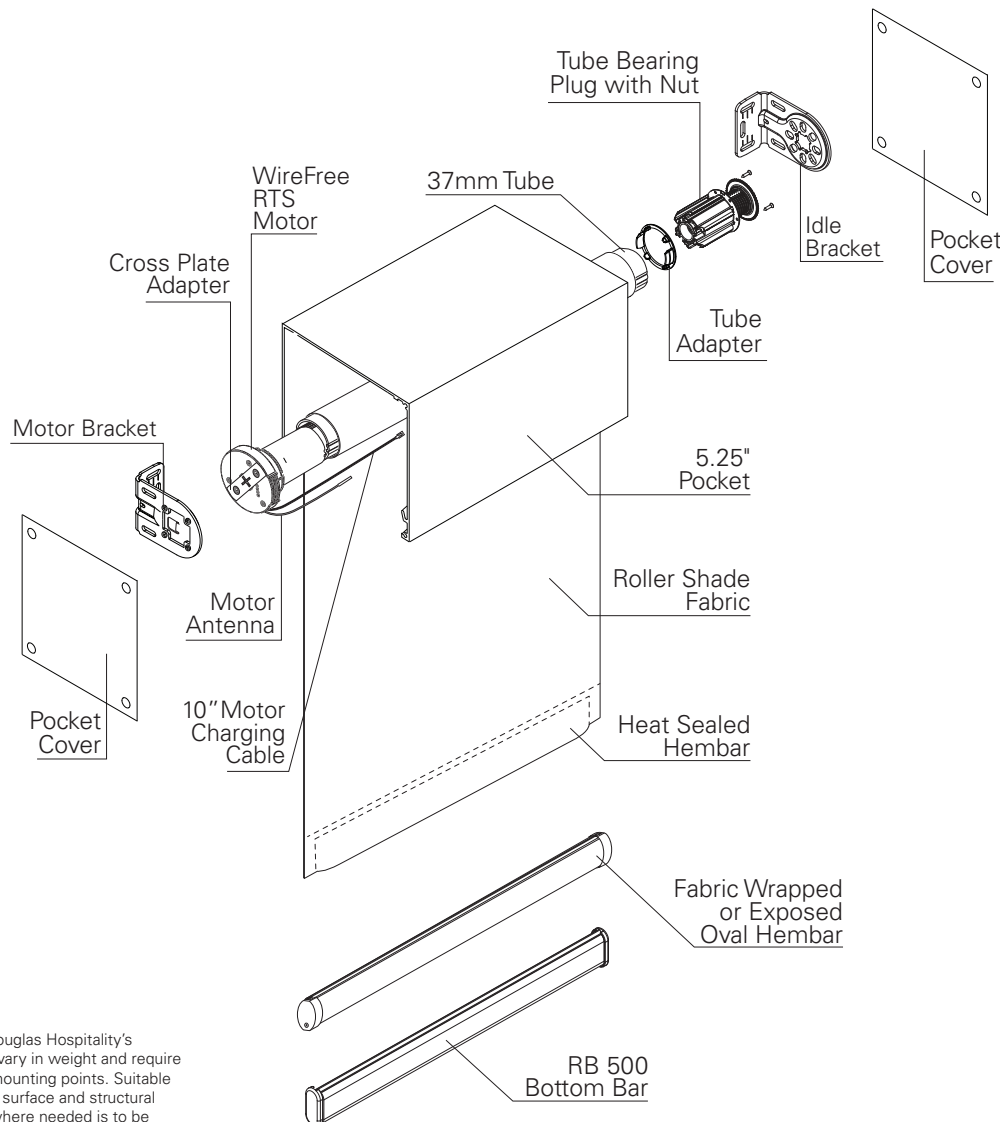

Hunter Douglas Hospitality's products vary in weight and require specific mounting points. Suitable mounting surface and structural support where needed is to be provided by others.

Las Vegas • Chicago

800.229.5300

HDhospitality.com

© 2018 Hunter Douglas. All rights reserved. All trademarks used herein are the property of Hunter Douglas or their respective owners.

**HunterDouglas**  
Hospitality