

## TOOLS NEEDED

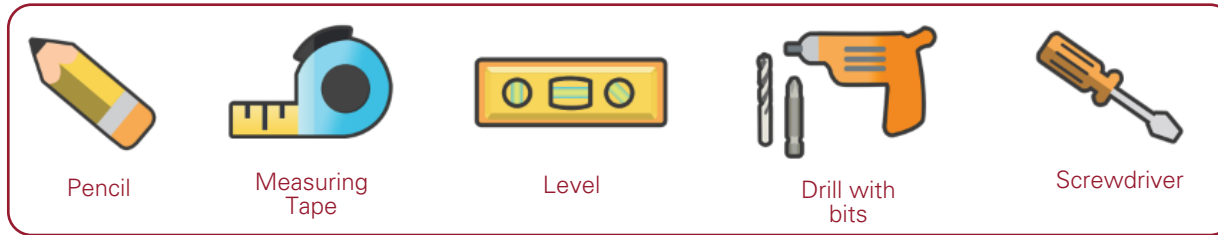

Hunter Douglas Hospitality's products vary in weight and require specific mounting points. Suitable mounting surface and structural support where needed is to be provided by others.

## BRACKET OPTIONS

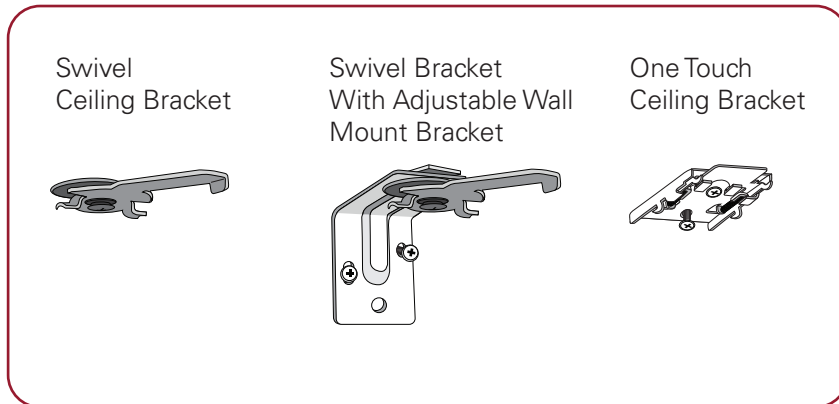

## BRACKET SPACING

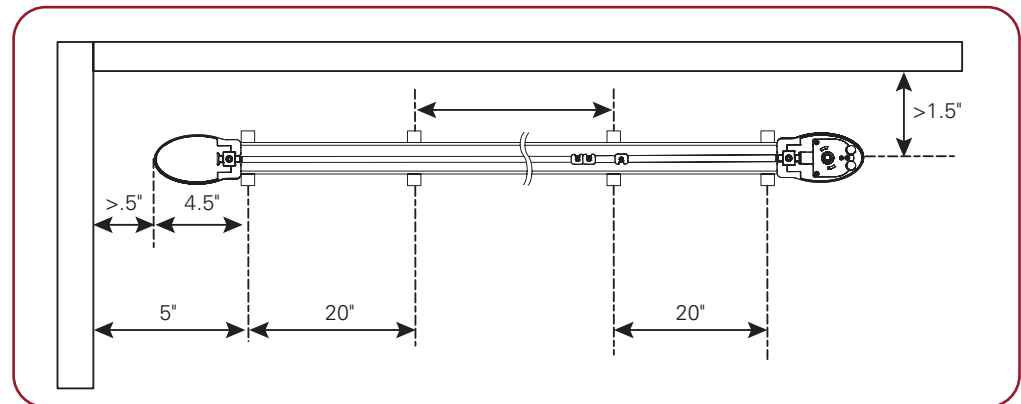

## TRACK INSTALLATION with Swivel Ceiling Bracket

Mount into wood or metal studs or into concrete with concrete anchors. Drywall anchors are not recommended.

- 1) Mark the position of the bracket. See bracket spacing illustration above.
- 2) Drill the ceiling or the wall at the marked positions.
- 3) Attach the brackets.
- 4) Place the rail on to the brackets. Push the bracket levers to lock the track in place. Check that the track is level and aligned

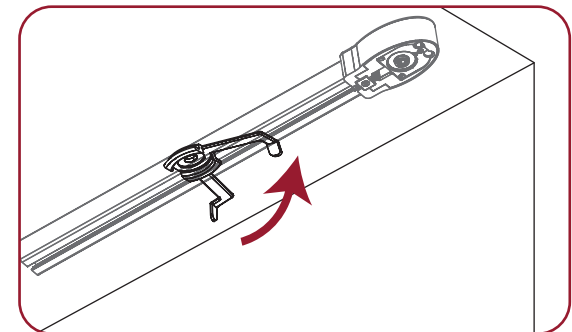
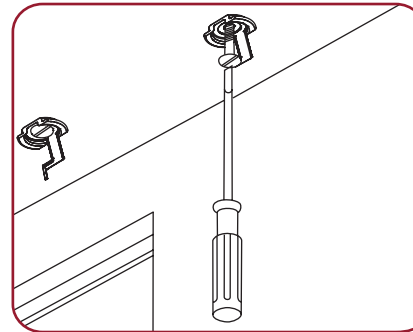
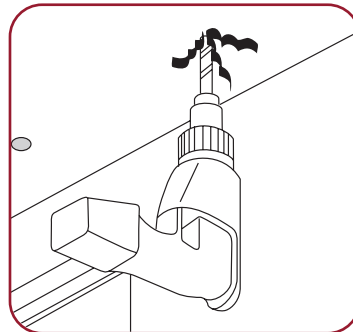
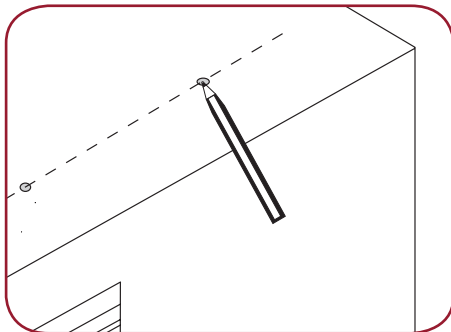

Glydea® and Irismo™ are registered trademarks of Somfy.

## MOTOR INSTALLATION

1) Unlock the motor

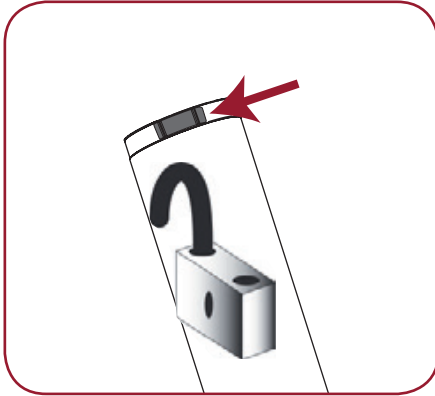

1) Insert the motor shaft into the drive pulley hole

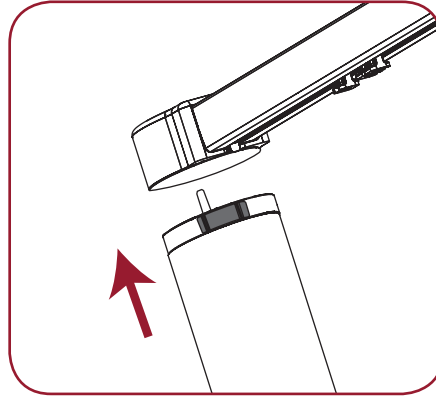

3) Lock the motor

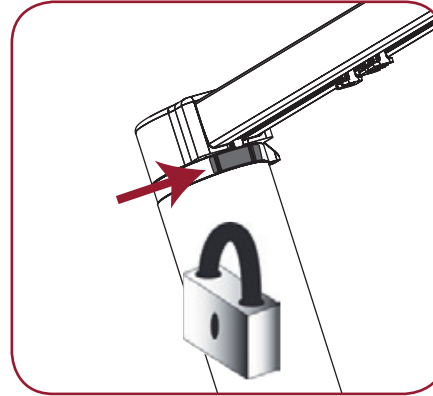

## IRISMO® BATTERY INSTALLATION

1) Connect the battery pack into the bottom of motor.

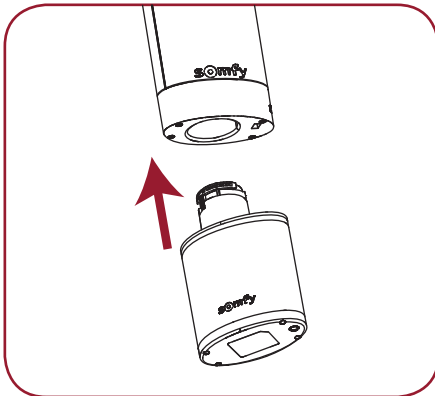

2) Twist the battery pack until it clicks. This is the locked position. If the battery pack is not weak, the motor will emit one “beep” and the green LED will blink for several seconds, then the motor is ready to work.

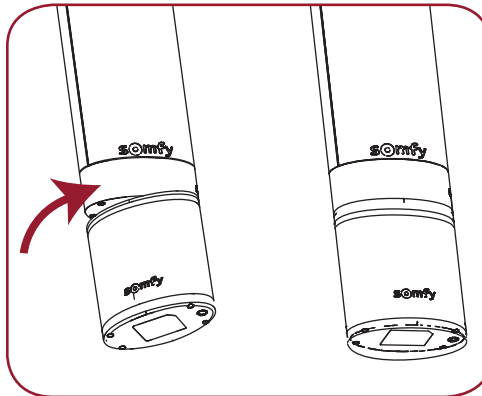

If battery pack is weak, the motor will emit one “beep” and the LED will blink red for several seconds. This means the battery must be charged.

## IRISMO® BATTERY CHARGING

- 1) Connect the power charger to the bottom of battery pack, or to the top of battery pack (if the battery pack is not connected to the motor).
- 2) After connecting the power charger to the battery pack, the red LED will come on. This is the charging mode.
- 3) When the LED turns green, the charge cycle is complete. Disconnect the power charger, and save it for later use.

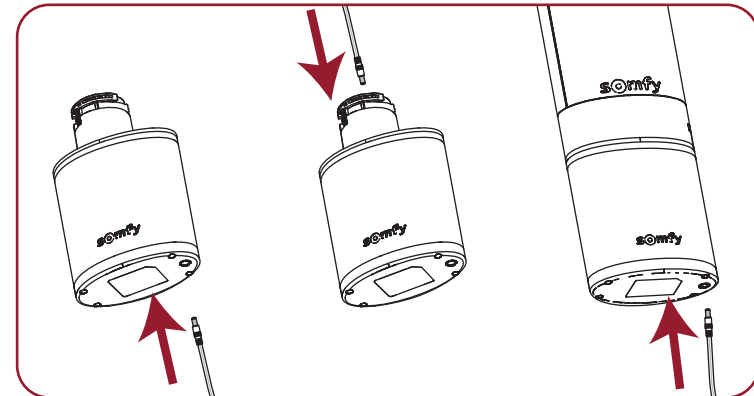

Use only the Somfy power charger with this motor. The motor can't be use while charging.

Glydea® and Irismo™ are registered trademarks of Somfy.

Las Vegas • Chicago  
800.229.5300  
HDhospitality.com