

# RB 500™ 4" Fascia - Sonesse 40 WireFree (li-ion) RTS Motor

## Diagram

### SPECIFICATIONS

Mount: **Ceiling, Wall, or End Mount**

Tube Size: **50mm (2")**

Minimum Shade Width: **35"**

Light Gap: **Motor End — 1"**

**Idle End — 1"**

Bracket Color: **Grey**

Bracket Cover Colors: **Black, Grey, & White**

Control Options:

**Wireless Wall Switch, Wireless Remote, Universal Interface, Timer, Sun Sensor, mylink™ RTS Smartphone, Tablet, and Amazon Alexa Interface**

Bracket	Dimensions	Max Roll Up
<b>4" Fascia</b>	<b>4" H x 1" W x 4" D</b>	<b>3-3/4" (3.75")</b>

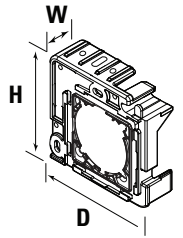

### FASCIA COLORS

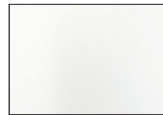

White

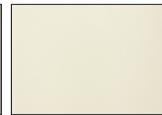

Vanilla



Aluminum

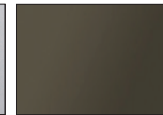

Bronze



Black

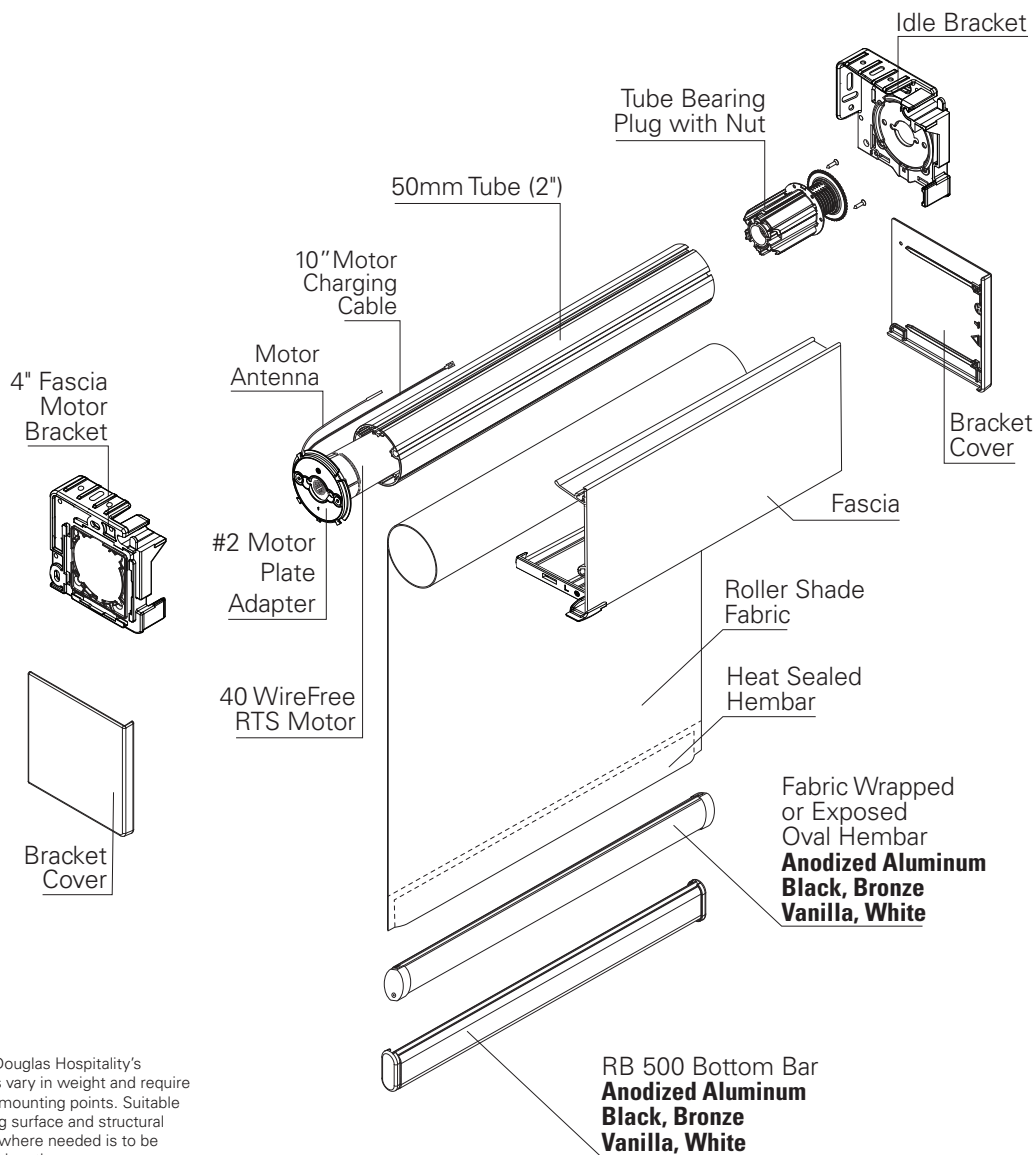

### OPTIONS

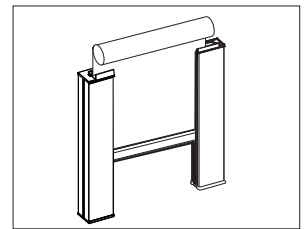

Side Channels

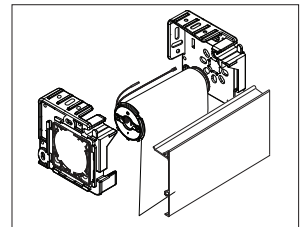

Reverse Roll Fascia

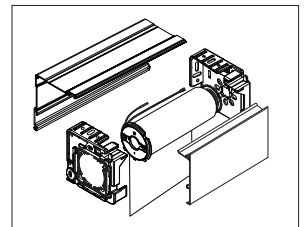

Back Fascia

### Plug-In Charger



Hunter Douglas Hospitality's products vary in weight and require specific mounting points. Suitable mounting surface and structural support where needed is to be provided by others.

Las Vegas • Chicago  
800.229.5300  
HDhospitality.com

© 2021 Hunter Douglas. All rights reserved. All trademarks used herein are the property of Hunter Douglas or their respective owners.

**HunterDouglas**  
Hospitality