

# RB 500™ Single Bracket - Sonesse 40 WireFree RTS Motor

## Diagram

### SPECIFICATIONS

Mount: **Ceiling, Wall, or End Mount**  
 Shade Width: **50mm (2") Tube — 35" - 120"**  
 Light Gap: **Motor End — 3/4" (.75")**  
**Idle End — 3/4" (.75")**

Motor connection: **Built-in Rechargeable Battery**  
 Power connector: **10" Motor Charging Cable Plug**  
 Bracket Color: **Grey**

Bracket Cover Colors: **Black, Grey, & White**  
 Control Options: **Wireless Wall Switch, Wireless Remote, Universal Interface, Timer, Sun Sensor, mylink™ RTS Smartphone, Tablet, and Amazon Alexa Interface**

Bracket	Dimensions	Max Roll Up
<b>Bracket 38</b>	<b>1.96" H x 1.22" W x 2.44" D</b>	<b>3.24"</b>
<b>Bracket 46</b>	<b>1.96" H x 1.22" W x 2.79" D</b>	<b>3.56"</b>
<b>Bracket 55</b>	<b>1.96" H x 1.22" W x 3.14" D</b>	<b>3.94"</b>

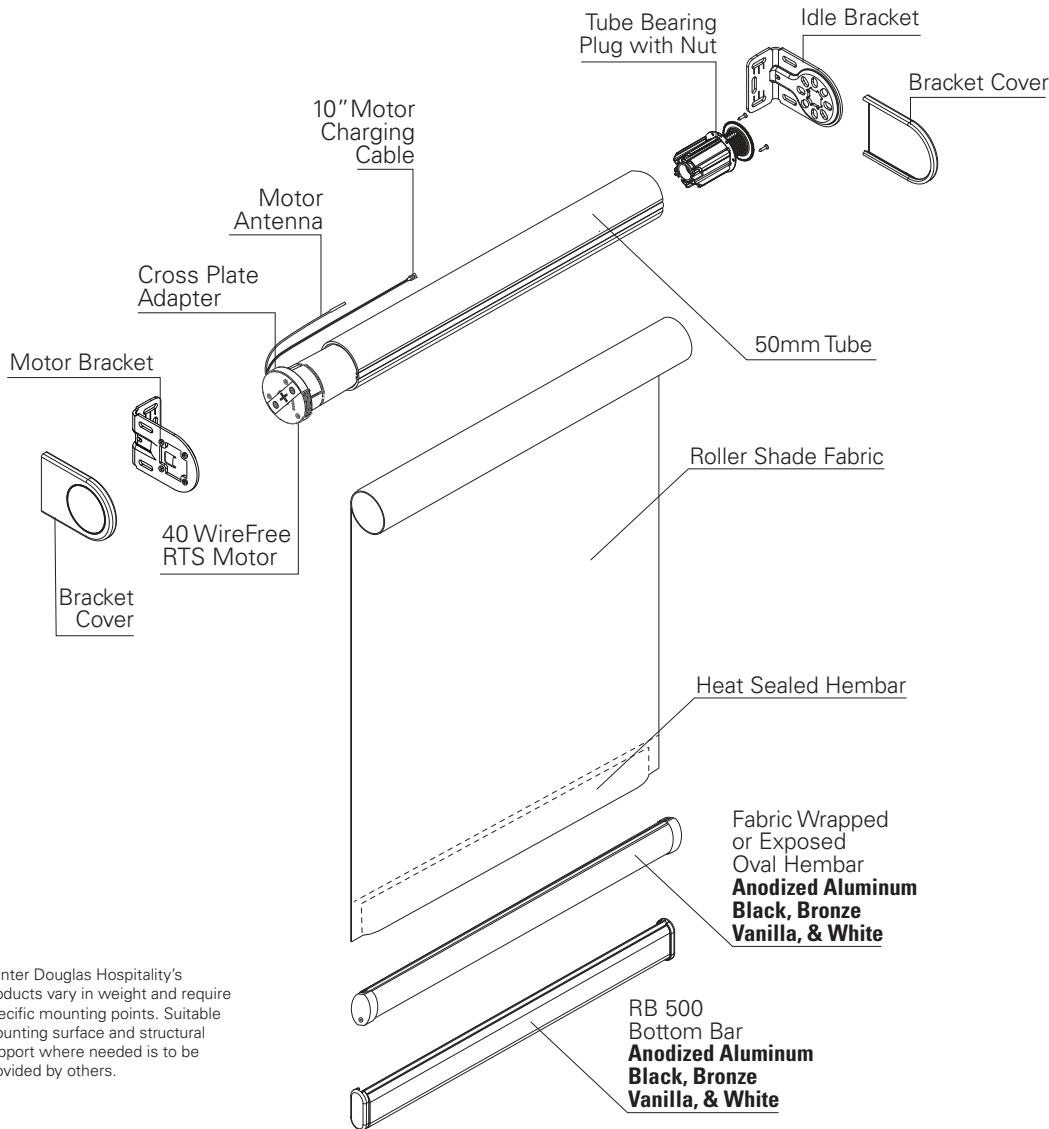
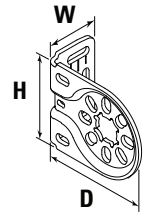

Hunter Douglas Hospitality's products vary in weight and require specific mounting points. Suitable mounting surface and structural support where needed is to be provided by others.

### OPTIONS

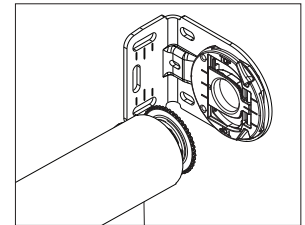

**Integrated Leveler**

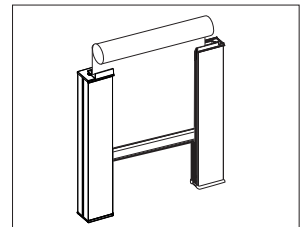

**Side Channels**

### Plug-In Charger



800.229.5300  
 HDhospitality.com

© 2021 Hunter Douglas. All rights reserved. All trademarks used herein are the property of Hunter Douglas or their respective owners.