

WIRELESS WALL SWITCH (TRANSMITTER)

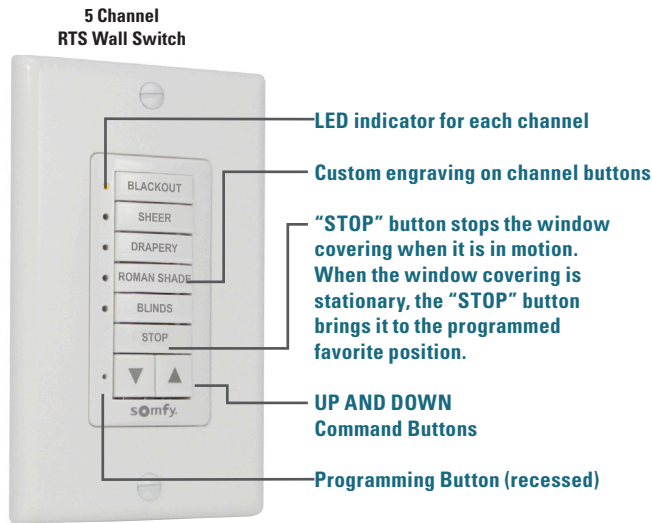

WIRELESS REMOTE CONTROL (TRANSMITTER)

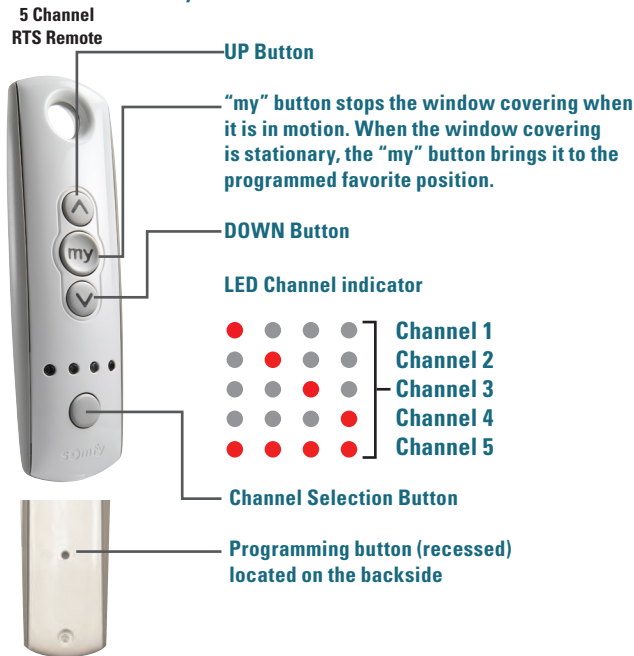

USER MODE

Adjusting the Limits in User Mode

Lower Limits

Step 1:

Press DOWN to send the window covering to its current LOWER Limit.

Step 2:

Press and hold both UP and DOWN simultaneously until the window covering jogs. Adjust to a new LOWER limit position.

Step 3:

Press and hold STOP/MY until the window covering jogs, to confirm new limit.

Upper Limits

Step 1:

Press UP to send the window covering to its current UPPER Limit.

Step 2:

Press and hold both UP and DOWN simultaneously until the window covering jogs. Adjust to a new UPPER limit position.

Step 3:

Press and hold STOP/MY until the window covering jogs, to confirm new limit.

Setting Intermediate Preferred "MY" Position

Step 1:

Press the UP or DOWN to operate window covering. At the desired intermediate "my" position press STOP/MY briefly to stop the window covering.

Step 2:

Once the desired "my" position is reached, press and hold STOP/MY until the window covering jogs. The "my" position is now added to memory.

Activating the "MY" Position

Send the window covering to the "my" position by pressing STOP/MY from ANY window covering position.

Window covering should be stationary prior to activating "my" position function. If window covering is actively moving (in-motion) STOP/MY should be pressed twice.

Deleting "MY" Position

Activate window covering to intermediate position, then press and hold STOP/MY for 5 seconds. Window covering will jog to confirm deletion of "my" position.

Adding, Deleting, Copy/Paste a Transmitter Start with the Programmed Transmitter

Step 1:

Using an already programmed transmitter with the desired programming, select the transmitter (single channel) or the channel (1-5 of a multi-channel transmitter, or the sensor).

Step 1 should not be performed with the transmitter intended for deletion.

Step 2:

Using a paper clip, press and hold the PROGRAMMING BUTTON of that transmitter until the window covering jogs.

Step 3:

Select the transmitter (single channel) or the channel, (1-5 of a multi-channel transmitter, or the sensor) to be added, deleted or copied/pasted.

Step 4:

Using a paper clip, press and hold the PROGRAMMING BUTTON of that transmitter or sensor until the window covering jogs.

DEACTIVATE RTS MOTOR IN USER MODE

Step 1:

Press and hold the PROGRAMMING BUTTON on the previously programmed transmitter or motor head until the shade jogs. The motor is now in PROGRAMMING MODE.

Step 2:

Press and hold both the UP and DOWN buttons simultaneously until the window covering jogs once.

ENABLING RTS IN USER MODE

Activate RTS

Briefly press the motor head PROGRAMMING BUTTON. The shade will jog. The shade is now in User Mode.

Motor Head Programming Button



V1 Style



V2 Style